

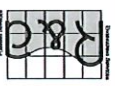





REEDS & ASSOCIATES, P.C.  
 221 First Oregon Street, Suite 200  
 Astoria, Oregon 97103  
 Phone: 541-325-2423  
 Fax: 541-325-2425



PROJECT NO. 17-0177  
 DATE: 12/21/17

LINN ECONOMIC DEVELOPMENT GROUP  
 MILLERSBURG, OREGON  
**SITE UTILITIES - INSET 2**  
 MID-WILLAMETTE VALLEY INTERMODAL CENTER

NO.	DATE	BY	DESCRIPTION
1	08/23/2017	AKA	ISSUED FOR PERMIT
2	08/23/2017	AKA	ISSUED FOR PERMIT
3	07/27/2017	AKA	ISSUED FOR PERMIT
4	07/20/2017	AKA	ISSUED FOR PERMIT
5	05/25/2017	AKA	ISSUED FOR PERMIT
6	05/25/2017	AKA	ISSUED FOR PERMIT
7	05/25/2017	AKA	ISSUED FOR PERMIT
8	05/25/2017	AKA	ISSUED FOR PERMIT
9	05/25/2017	AKA	ISSUED FOR PERMIT
10	11/17/2017	AKA	ISSUED FOR PERMIT

R&B PROJECT NO. LED1901  
 DATE: 12/21/17  
 DESIGNED: K. RICHIE  
 CHECKED: A. CROCHON  
 SCALE: AS SHOWN  
 SHEET NUMBER:

**5.2**

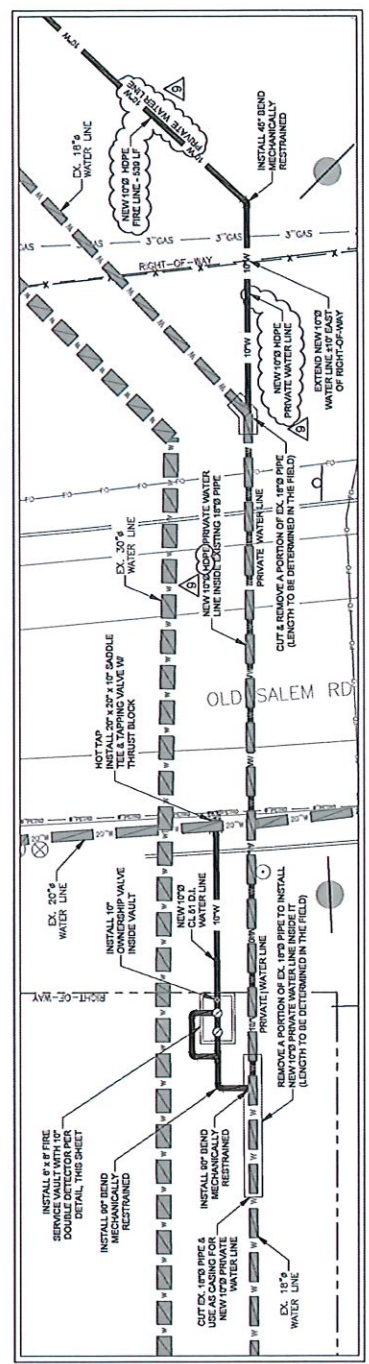
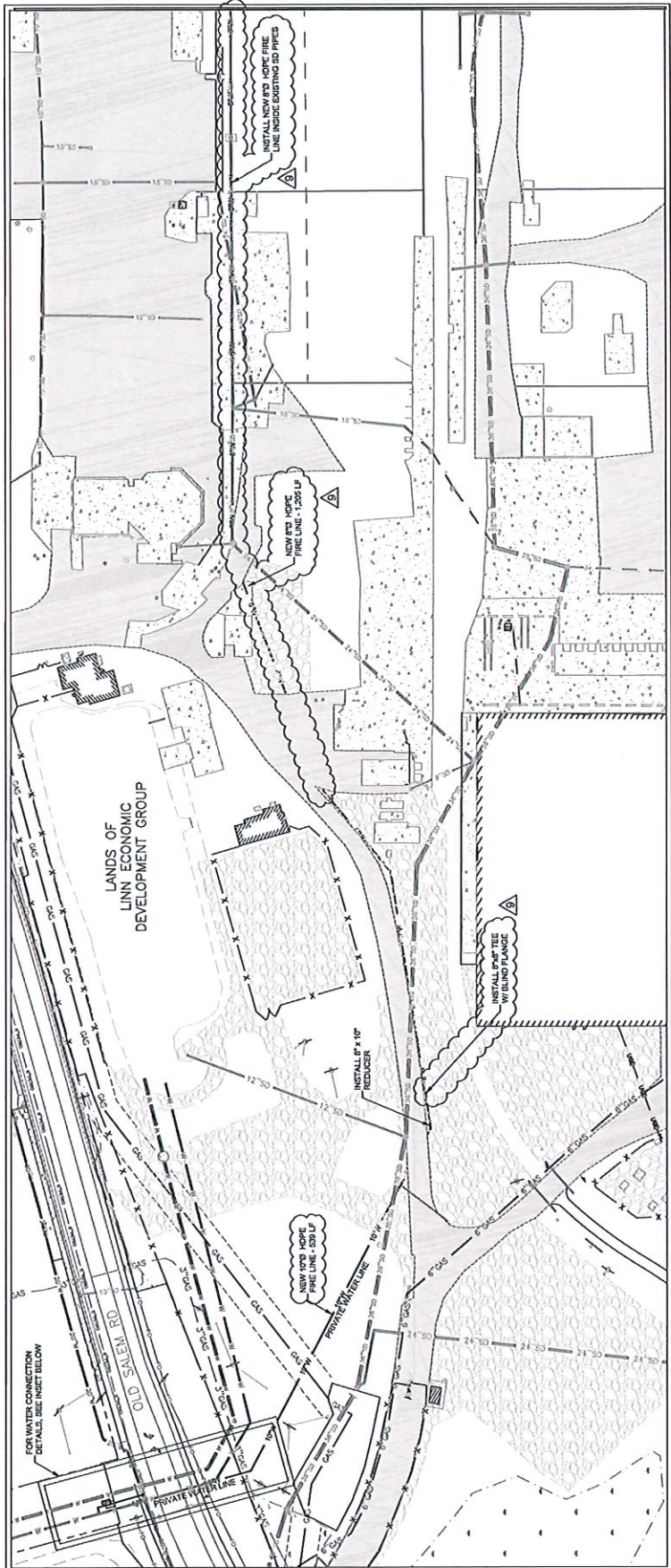

**WATER CONNECTION DETAIL**  
 SCALE: 1" = 30"

**INSET 2**  
 SCALE: 3" = 50"

MATCHLINE - SEE SHEET 5.1